



High Pressure Horizontal/Vertical
Multistage Centrifugal Pumps

EMS*series*



Coding System

E.g. **EMS 65 DL 25-15(I)x1 M BC**
XXX XXX-XXX-XX (X) X X XX

Series

EMS = Horizontal Multistage Centrifugal Pumps

EMS(V) = Vertical Multistage Centrifugal Pumps

Suction Size (mm)

Nominal Flow (m³/hr)

Duty Point Head (m)

1st Modification

Stage Numbers

Seal Type

M = Carbon - Ceramic/Viton M1 = Carbon - SiC/Viton (Optional)

*P = Gland Packing M2 = Carbon - SiC/EPDM

Impeller/Body Casing Material

BC = Bronze impeller and Cast Iron Body

BD = Bronze impeller and Ductile Iron Body

CC = Cast Iron impeller and Body

CD = Cast Iron impeller and Ductile Iron Body

KK = SS316 impeller and Body

KC = SS316 impeller and Cast Iron Body

SS = SS304 impeller and Body

SC = SS304 impeller and Cast Iron Body



Vertical Multistage Centrifugal Pumps



Horizontal Multistage Centrifugal Pumps

Description

EMS Series are vertically or Horizontally mounted multistage high pressure pump in sectional construction with opposing suction and discharge port of same nominal width or in-line-execution possible.

Pumping media:

It is suitable for clean fluid pumping media without abrasive, solid or long-fibre particles.

Construction:

This series includes single-suction, multi-stage, segmental, centrifugal pumps. Installation mounting on either vertical & horizontal. There are 9 installation positions including multi-outlet available for vertical & horizontal types. Vertical pump is driven by the upper vertical motor through flexible coupling. The rotary direction of pump is counterclockwise as being viewed from the motor part. Horizontal pump is driven by horizontal motor through flexible coupling. The rotary direction is clockwise as viewed from the motor side. Mechanical seal or soft packing seal. There is replaceable shaft sleeve as for the application of soft packing seal.

Shaft sealing:

The pump is equipped with a maintenance-free cartridge-type mechanical seal. Standard material is silicon carbide/silicon carbide EPDM. Other mating of material is available upon request.

Specification:

Flange : DIN 2498 (std), ANSI B16.5B (optional)

Materials : GG25 (Cast iron), G-CuSn10 (Bronze), Stainless Steel

Mounting : Bare Shaft, Engine Driven, Closed Coupled (EMSM)

Operating Range:

DN	32 - 200
Q	500m ³ /hr
O.P.	up to 40bar (std) 50bar (optional)
H	400m

Application:

- Water Supply
- Fire Protection and Sprinkler Installation
- Boiler Feed
- Irrigation and agriculture
- High Pressure Pumping

General Drawings

Horizontal Multistage Centrifugal Pumps

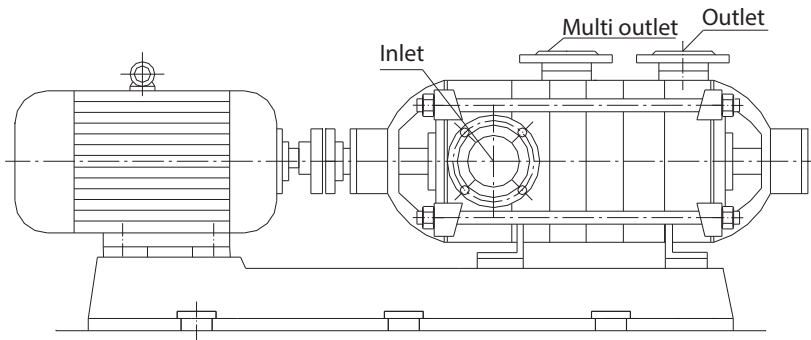

Front View

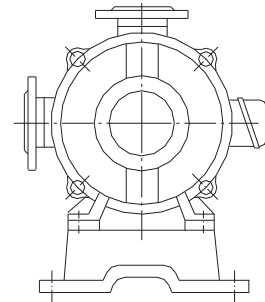

Side View

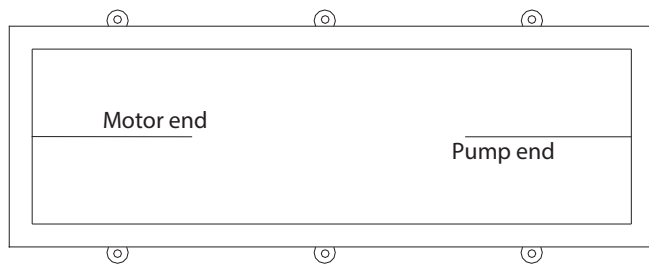

Direction A

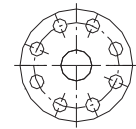

Suction Flange

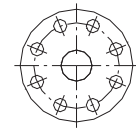

Discharge Flange

Vertical Multistage Centrifugal Pumps

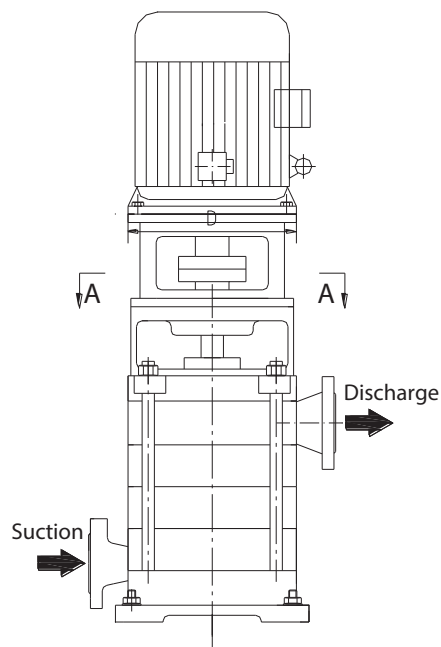

Front View

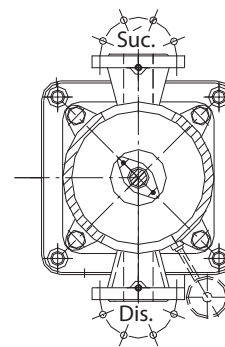

A - A Direction

EMS Performance - 50Hz

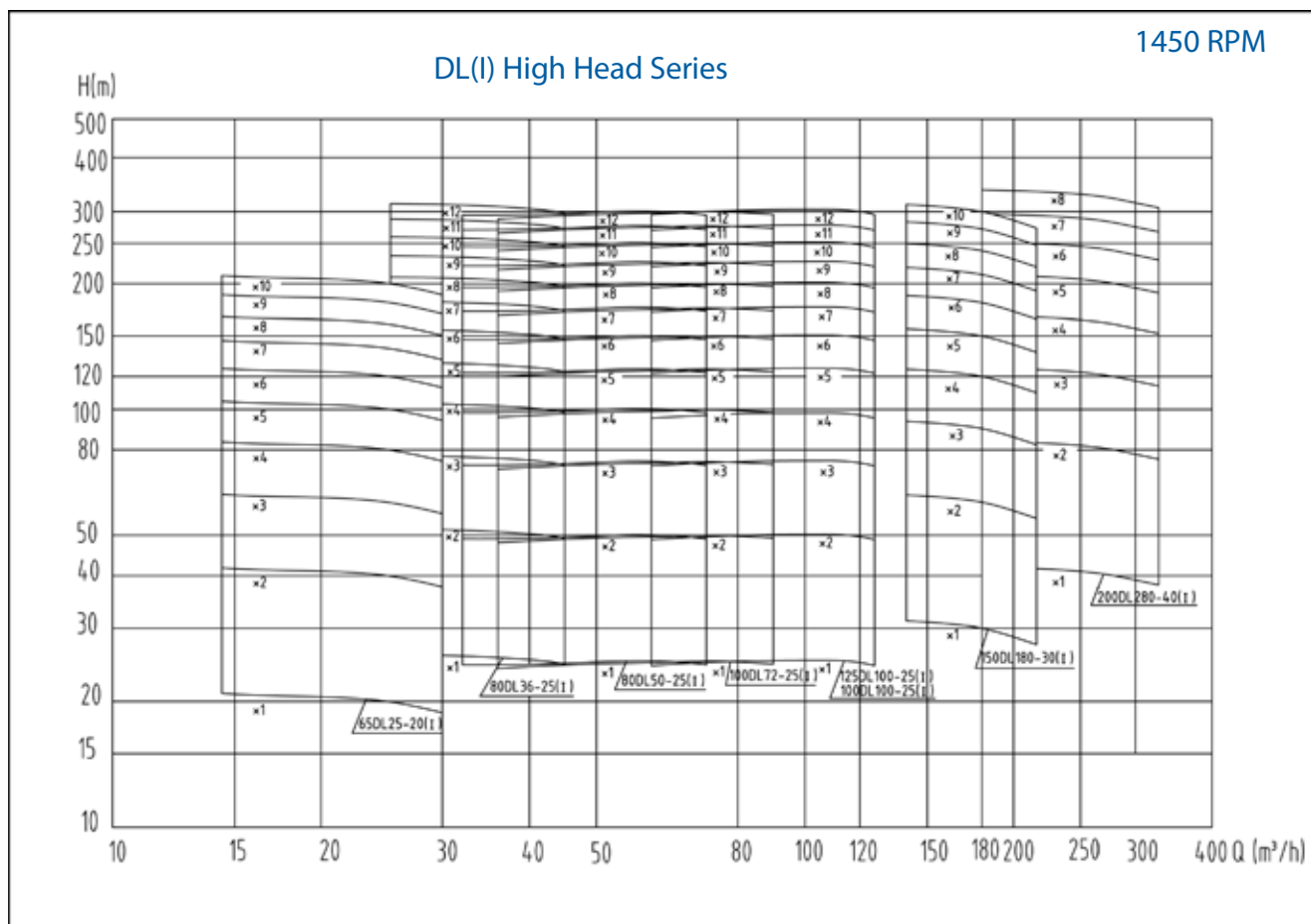
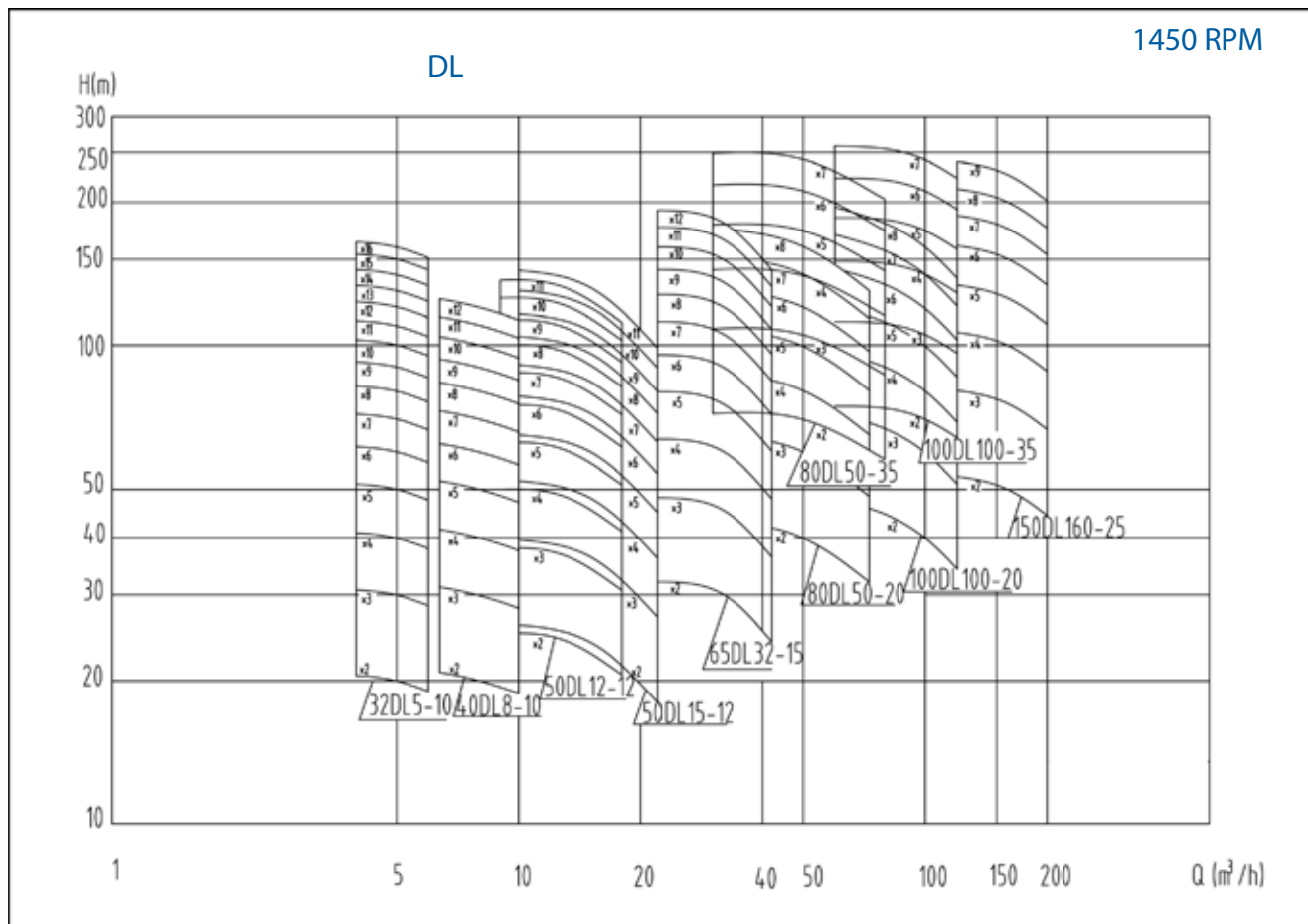

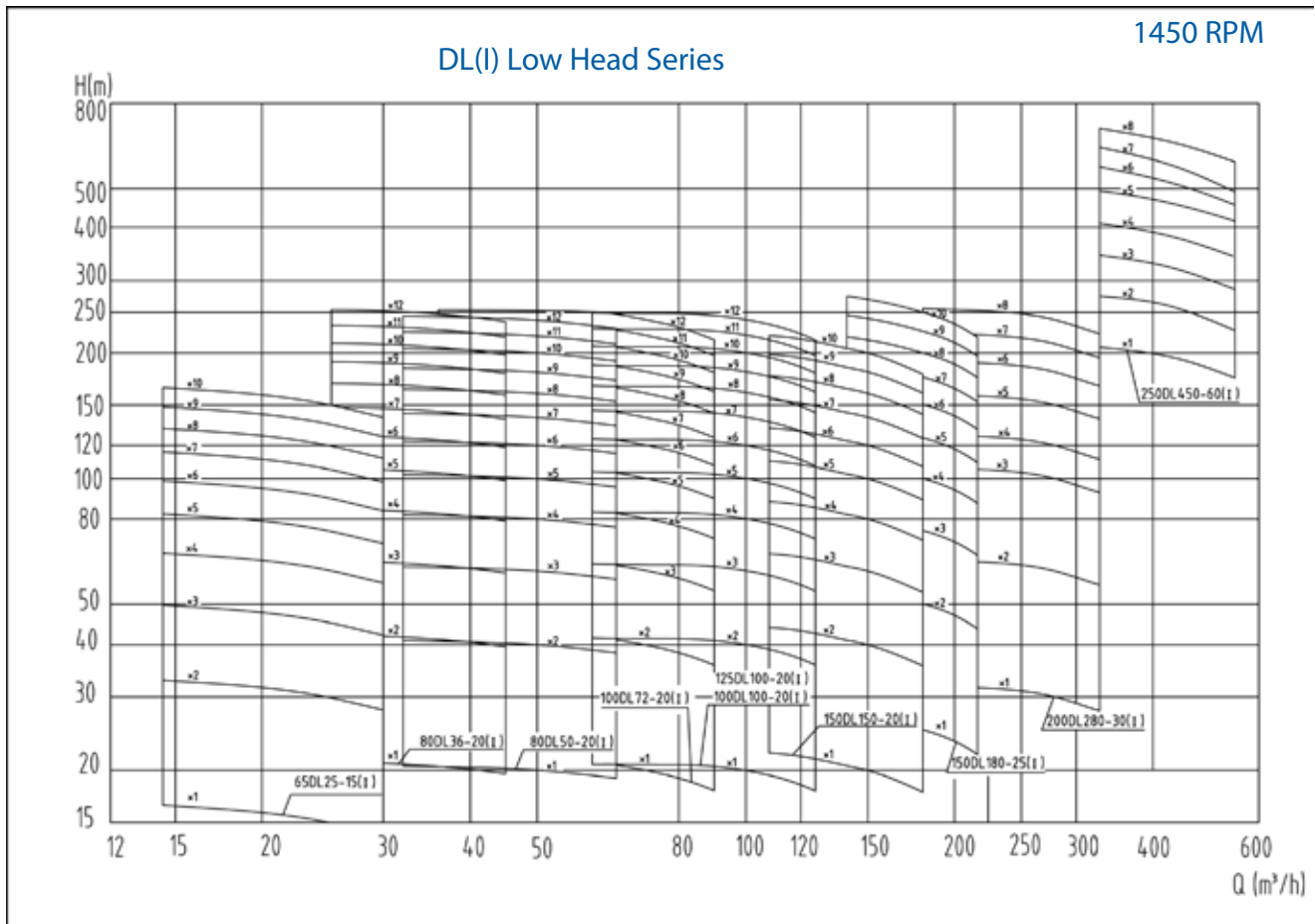

Your Local Distributor Details :

A large, empty rounded rectangular box intended for the user to enter their local distributor details.



Euroflo Pumps International Pte Ltd

No.1 Joo Koon Way Singapore 628942 Tel: +65 68613836 Fax: +65 68613936